

CERTIFIED RECORD OF LAND CORNER MONUMENTATION

History of original corner establishment:
New corner

*

DIAGRAM
T10S R32E
C1/4
+
S12

Description of corner evidence found:

Description of monument and accessories I establish to perpetuate the original location of this corner:

Set a 2½x30" aluminum monument 20" in the ground in a mound of stone.

An 8" P.Pine bears S53°01'E 16.2 ft, scribed C1/4S12BT.

A 10" P.Pine bears S60°46'W 12.3 ft, scribed C1/4S12BT.

T10S R32E
C1/4
+
S12
PLS1918
1989

New BTs have 3/4" brass washers marked PLS1918 attached to the BT blaze, faces and bands painted with red tree marking paint, and BT tags and Land Survey Monument signs. A steel fence post with Land Survey Monument sign is driven approximately 3-5 feet from the corner.

Sun Cadastral Survey, 53-04H1-7-4011
Project No. 8722LC
Field Book: 8-22
Work Accomplished: 9/7/89
Witnesses: Louise Parsons

PARSONS SURVEYING
1915 S.E. Stone Street
Corvallis, OR 97333
(503) 752-7515

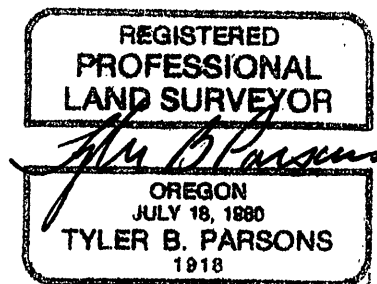

Office of County Surveyor County of GRANT
State of OREGON, I hereby certify that the within instrument was filed in this office
for record on the 21 day of NOV, 19 89

Robert D. Bayett by _____
(COUNTY OFFICIAL) (DEPUTY)